

## How to reverse the polarity(positive/negative) for 9005/9006 HID Kit.

### Step 1



Find the female connector for the 9005/9006 wire harness.

### Step 2



Find a pin or needle tool with a sharp tip.

### Step 3



With the sharp tip tool, gentle push on the lever that is holding the RED wire prong.

## **Step 4**

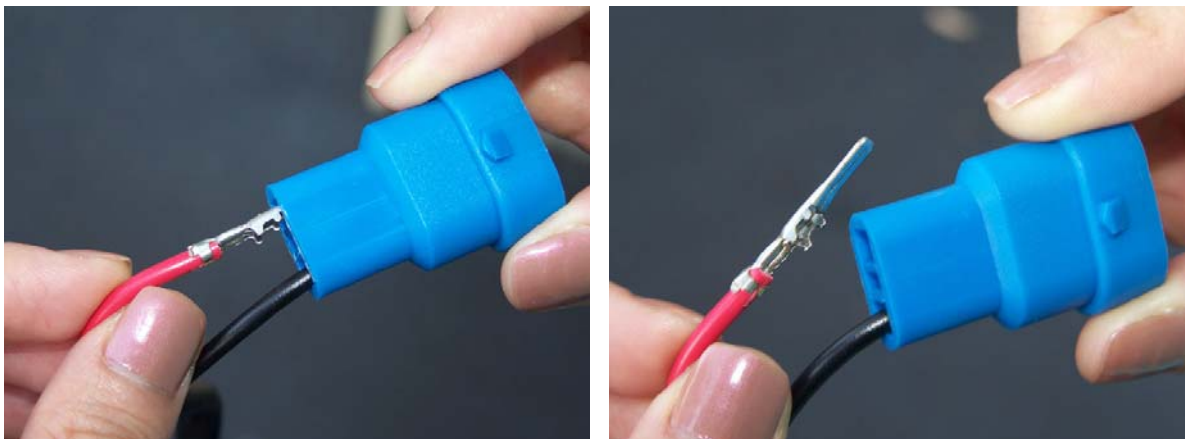

After gently push on the lever with the sharp tip tool, simply pull the prong out from the connector. Repeat Step 2 and Step 3 for the BLACK wire.

## **Step 5**

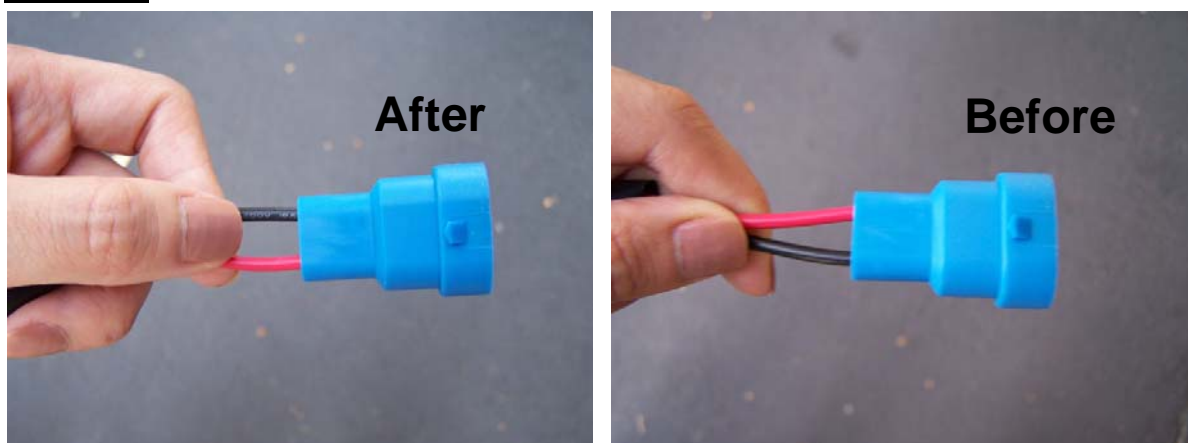

When both Red and Black wires are removed from the connector, reverse their position and insert the wires back in to the connector.

## **Step 6**

Repeat Step 1 to Step 5 for the other wire harness, and simply follow the installation guide (included in the kit) to install your 9005/9006 HID kit.